



## Feature

- 
- 
- 
- 

## Pin Description



TO-220FB-3L





TO-263-2L

## Applications

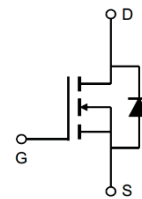
- 
- 
- 
- 



## Ordering and Marking Information

		
---	---	--

**Absolute Maximum Ratings**

Symbol	Parameter	Rating	Unit
<b>Common Ratings</b>			
<b>Mounted on Large Heat Sink</b>			
$\theta$			
$\theta$			

**Electrical Characteristics**

Symbol	Parameter	Test Conditions	HYG067N07NQ1			Unit
			Min	Typ.	Max	
<b>Static Characteristics</b>						
		$\mu$				
						$\mu$
						$\mu$
		$\mu$				
		$\pm$				
						m
<b>Diode Characteristics</b>						
		$\mu$				

## Electrical Characteristics (Cont.)

Symbol	Parameter	Test Conditions	HYG067N07NQ1			Unit
			Min	Typ.	Max	
<b>Dynamic Characteristics</b>						
<b>Gate Charge Characteristics</b>						

## Typical Operating Characteristics

Figure 1: Power Dissipation

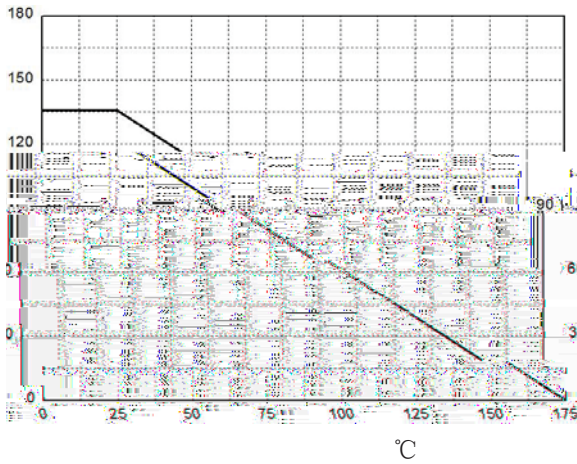

Figure 2: Drain Current

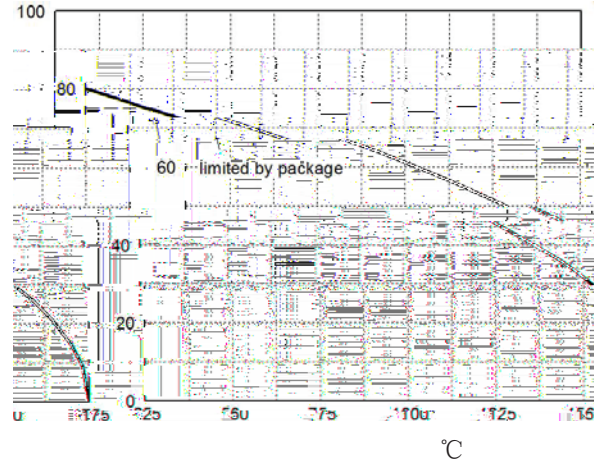

Figure 3: Safe Operation Area

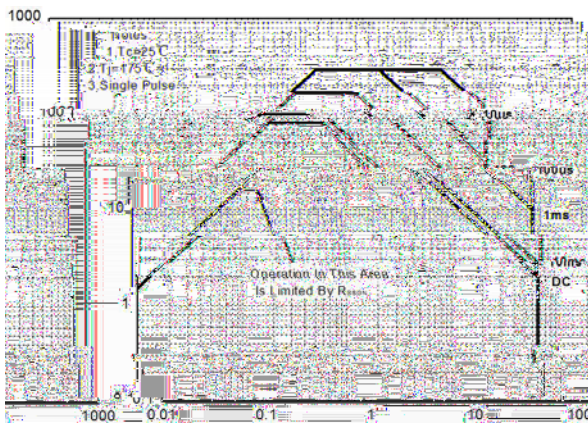

Figure 4: Thermal Transient Impedance

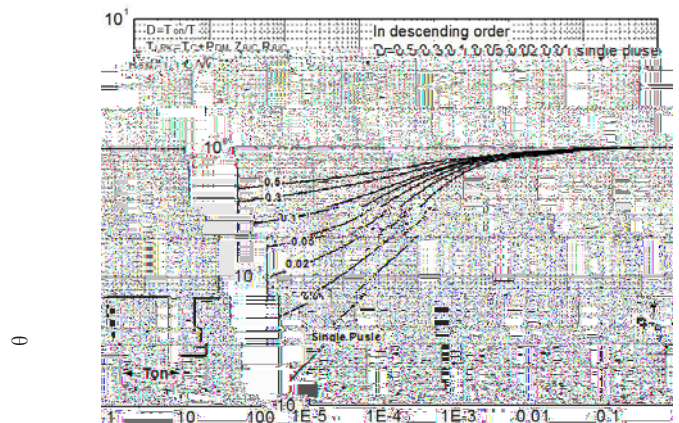

Figure 5: Output Characteristics

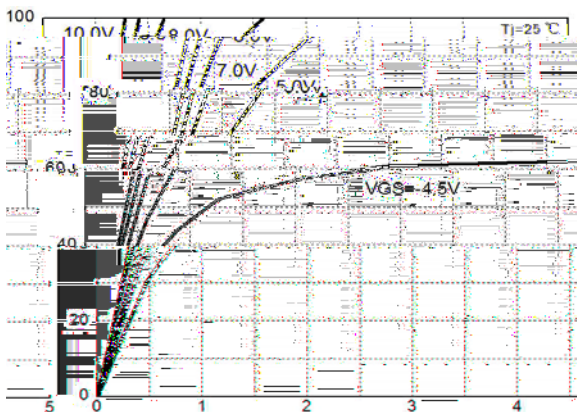
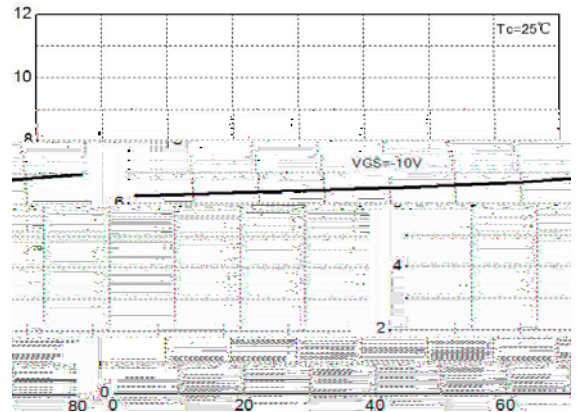

Figure 6: Drain-Source On Resistance



## Typical Operating Characteristics(Cont.)

Figure 7: On-Resistance vs. Temperature

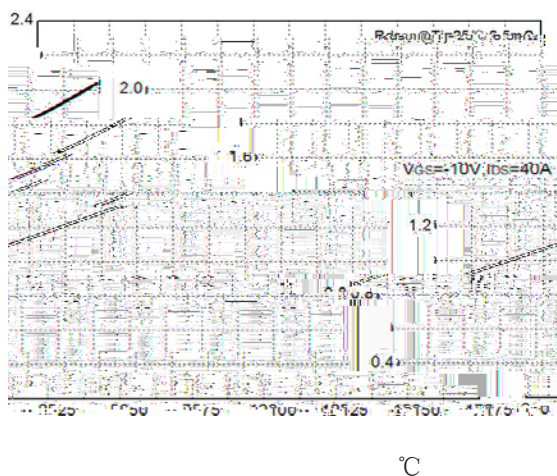

Figure 8: Source-Drain Diode Forward

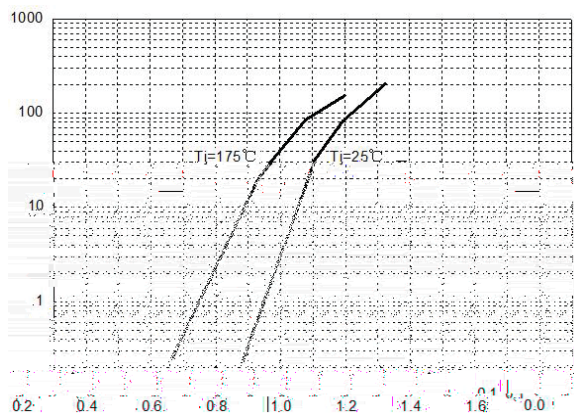

Figure 9: Capacitance Characteristics

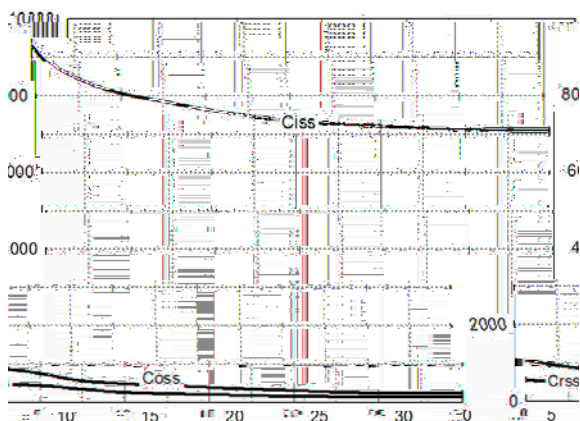
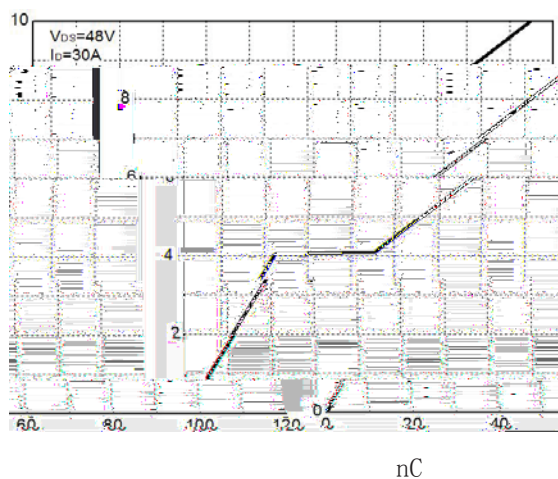
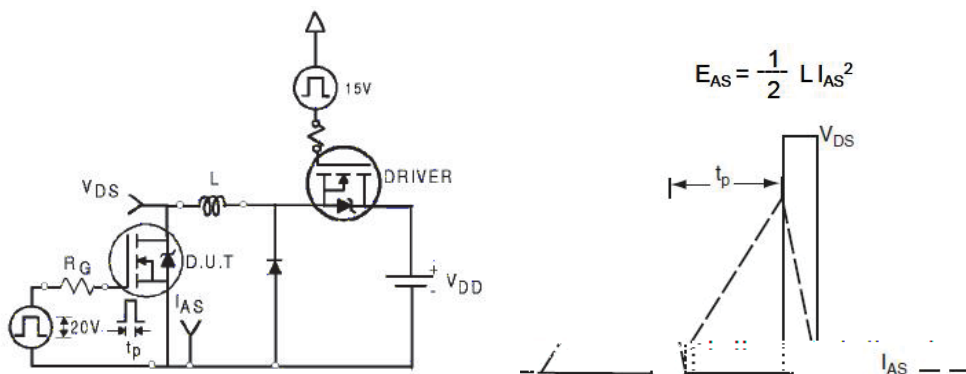

Figure 10: Gate Charge Characteristics



### Avalanche Test Circuit



### Switching Time Test Circuit

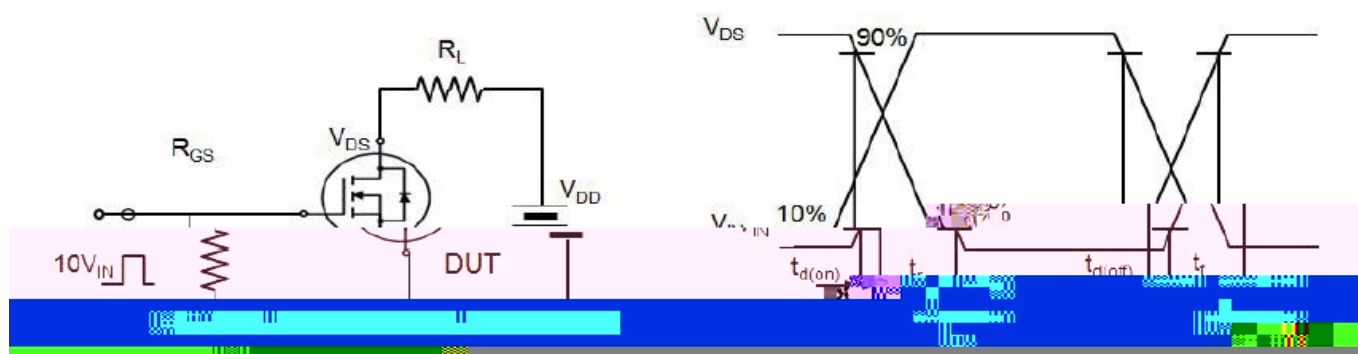

### Gate Charge Test Circuit

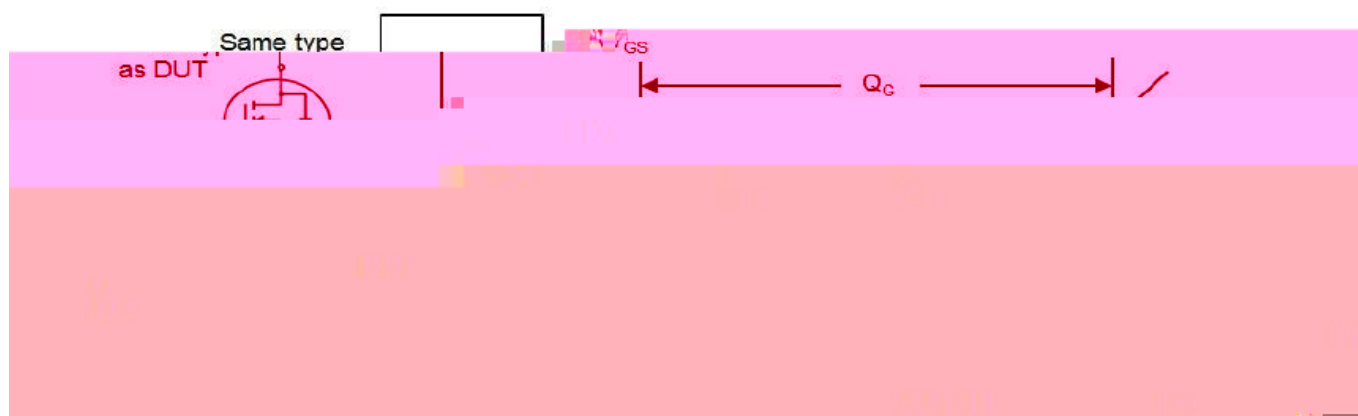

## Device Per Unit

Package Type	Unit	Quantity

## Package Information

TO-220FB-3L

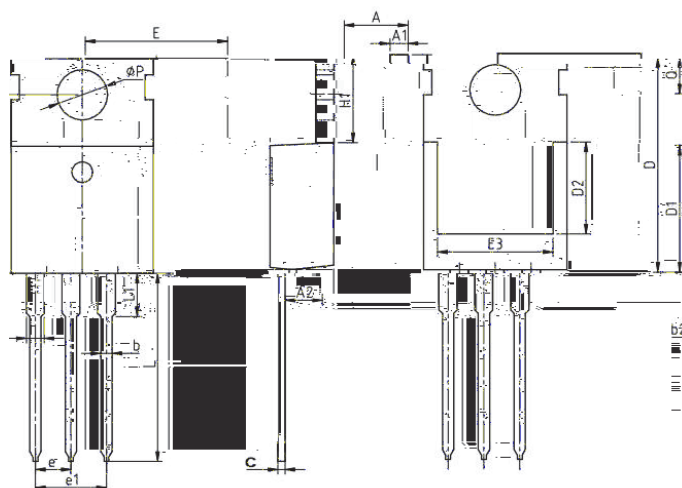

## Device Per Unit

Package Type	Unit	Quantity

## Package Information

### TO-263-2L

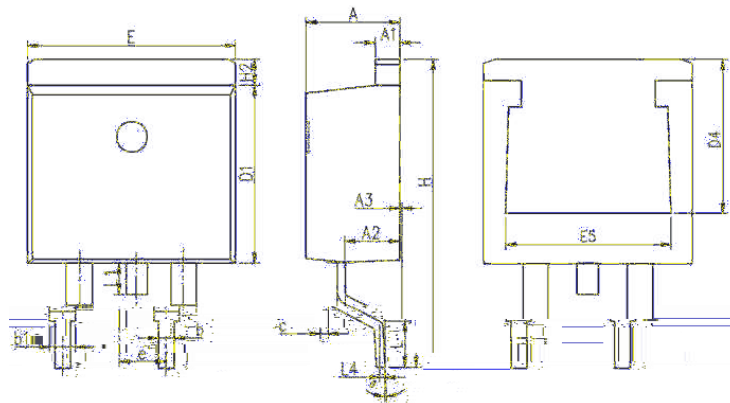



**Classification Profile**

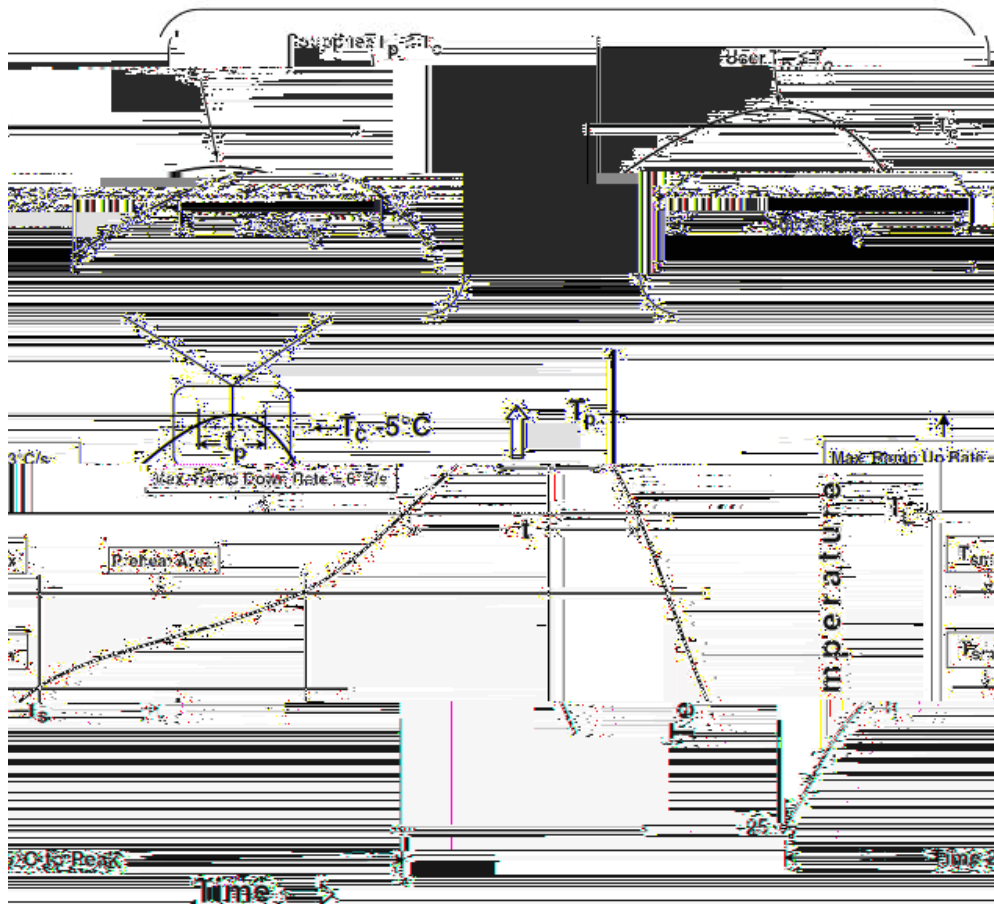

**Classification Reflow Profiles**

Profile Feature	Sn-Pb Eutectic Assembly	Pb-Free Assembly
Preheat & Soak		

# HYG067N07NQ1P/B

---

Package Thickness	Volume mm <sup>3</sup> <350	Volume mm <sup>3</sup> ≥350
<		

Package Thickness	Volume mm <sup>3</sup> <350	Volume mm <sup>3</sup> 350-2000	Volume mm <sup>3</sup> ≥2000
≥			

## Reliability Test Program

Test item

Method

Description

